



Chem-Tech

UPPER UNIT

Manufacturing Material: The manufacturing material used is galvanized sheet metal coated with electrostatically applied paint with a thickness of 1 millimeter.

Body: Galvanized sheet metal coated with electrostatically applied paint.

Doors: Galvanized sheet metal coated with electrostatically applied paint, consisting of two layers.

Handles: Stainless steel handles.

Door hinges: Soft close hinges, manufactured by Tarka.

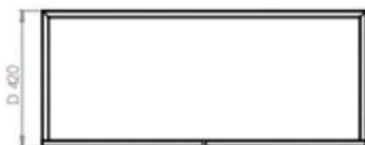
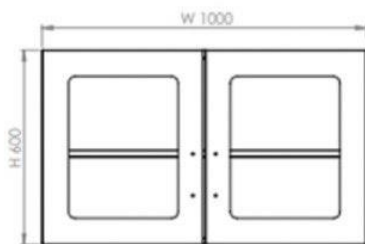
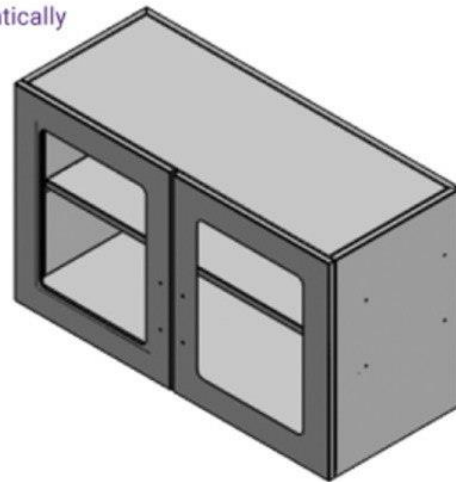

Unit Dimensions:

Width: 100cm

Height: 60 cm

Depth: 42 cm